

PROPRIETARY NOTICE: This document contains proprietary information of AeroAntenna Technology, Inc. (AAT). Neither the document nor said proprietary information shall be published, reproduced, copied, disclosed or used for any purpose other than consideration of this document without the express written permission of a duly authorized representative of said AeroAntenna Technology, Inc.

REVISIONS			
SYM	DESCRIPTION	DATE	APPROVED
B	UPDATED PER ECO 8732	04/08/09	
4	ADDED DIMENSION TO SPECIFY CONNECTOR LOCATION		

NOTES: UNLESS OTHERWISE SPECIFIED.

- 1 O-RING #2-156 SUPPLIED BY AEROANTENNA.
- 2 LABEL SIZE, SHAPE AND CONTENTS SUBJECT TO CHANGE WITHOUT NOTICE.
- 3. TOLERANCES: .XX ± .03
.XXX ± .010
- 4. SYMBOL ⊕ INDICATES CHANGES SINCE LAST REVISION.

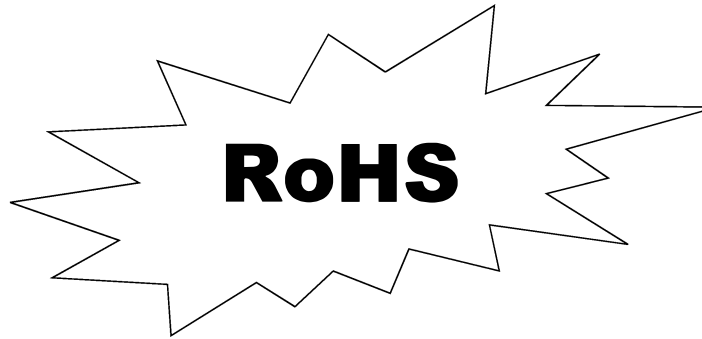

SPECIFICATION:

FREQUENCY: 1525-1615.5 MHz (L-BAND + GPS L1 + GLONASS "G1")
1217-1260 MHz (GPS L2 + GLONASS "G2")

POLARIZATION: RIGHT HAND CIRCULAR
AXIAL RATIO: 3 dB MAX
RADIATION COVERAGE: 6.0 dBic 0° = 0°
-2.0 dBic 0° < θ < 75°
-3.0 dBic 75° ≤ θ < 80°
-4.0 dBic 80° ≤ θ < 85°
-5.0 dBic HORIZON

AMPLIFIER:
NOISE FIGURE: 2.6 dB MAX
IMPEDANCE: 50 OHMS
VSWR: ≤2.0:1
BAND REJECTION: 20 dB @ 250 MHz
POWER HANDLING: 1 WATT
FINISH: FLUID RESISTANT
WEIGHT: 1.0 LBS. MAX
ALTITUDE: 70,000'
OPERATING TEMP: -55°C TO +85°C
DESIGNED TO: D0-160D
ENV CAT: E1-ABB[CLMY]XSFDZSAAACPH[A3][2A]CA



PART NO. DESIGNATION:

AT1675-32X-XXXX-XXX-XX-XX-XX-X

COLOR
W = WHITE

CONNECTOR
SMAF = SMA FEMALE
TNCF = TNC FEMALE

CABLE LENGTH
* 000 = IN INCHES

RoHS
R = RoHS COMPLIANT

MAGNET
NM = NO MAGNET

GAIN (± 2 dB)
26 = 26 dB (40 mA)
38 = 38 dB (60 mA)
XX = OTHER

VOLTAGE
RG = 4.2 TO 15.0 VDC

* = OPTION NOT AVAILABLE WITH THIS MODEL
STANDARD MODEL= AT1675-32W-SMAF-000-RG-26-NM-R

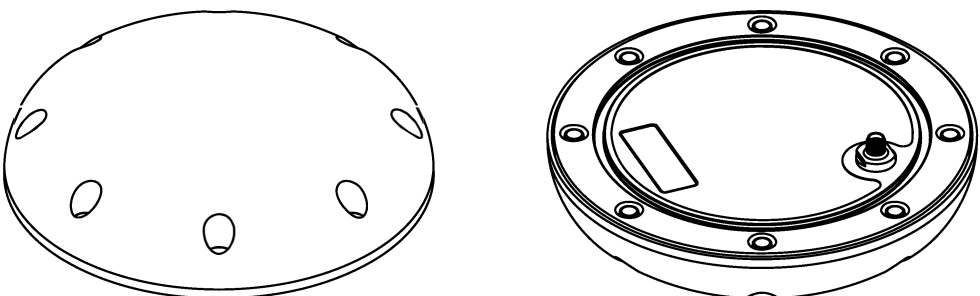
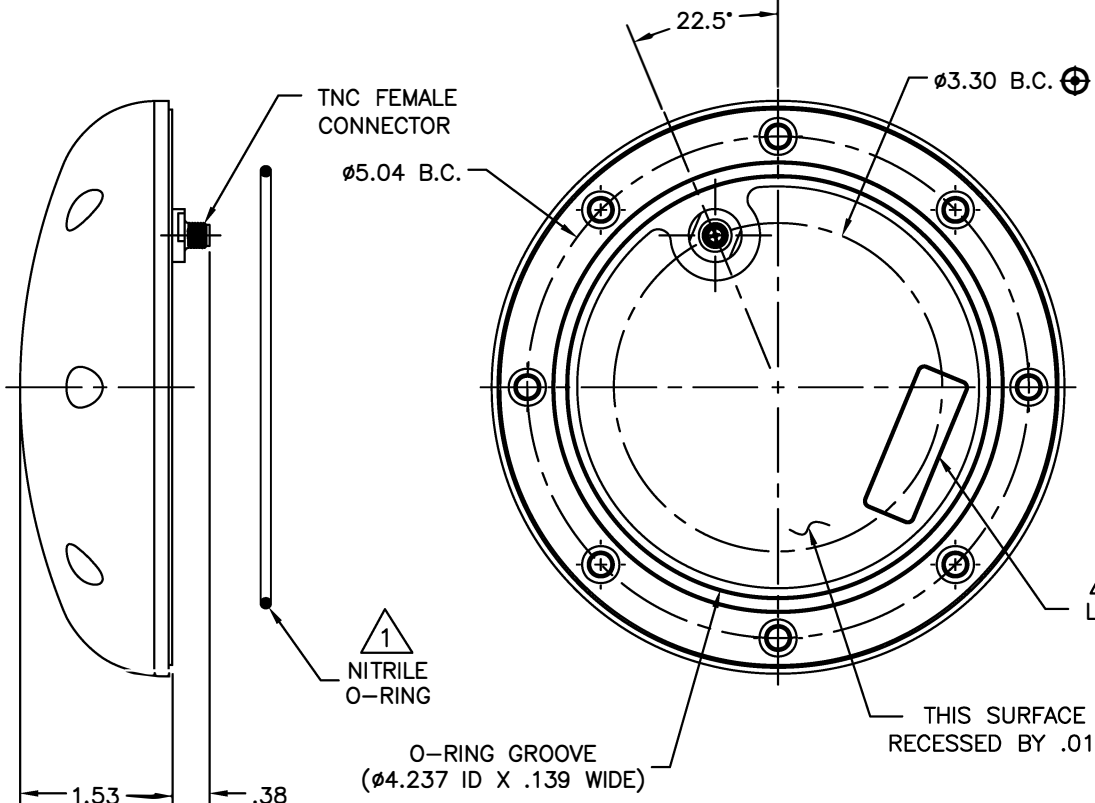
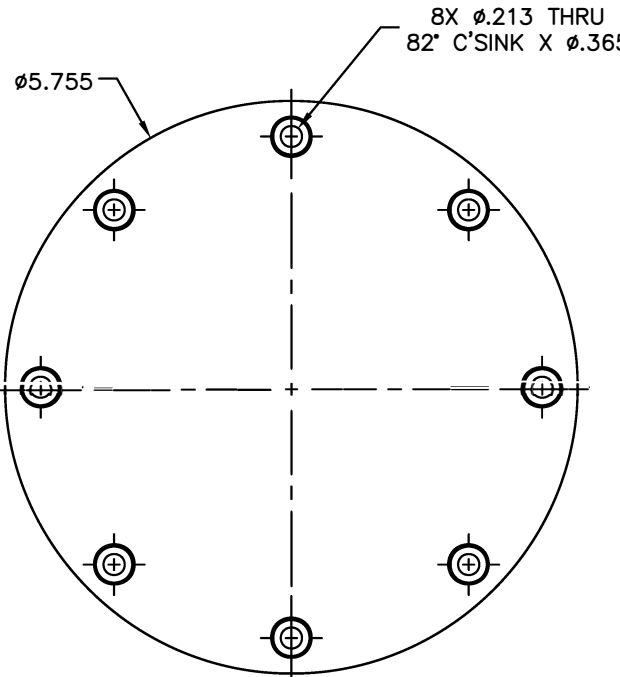

3D REFERENCES

DO NOT SCALE THIS DRAWING	DRAWN	J. GUTIERREZ	08/14/08
REMOVE BURRS AND BREAK SHARP EDGES:	CHECKED		
PART TO BE CLEAN AND OIL FREE	ENGR	E. NABOYSHCHIKOV	12/18/08
ALL DIMENSIONS ARE IN INCHES DIMENSIONING & TOLERANCING PER ASME Y14.5M-1994	MFG	DANNY LEVY	12/12/08
TOLERANCES:	Q.A.	B. RUBENI	12/18/08
∅K ±.01 FRACT = ±1/32	APPROVED	YOUSSI Z.	01/08/09
∅K ±.005 ANG. = ±1/2°	DRAWN IN	MCAD	
✓ SURFACE ROUGHNESS MACHINED PARTS V63 MOLDED PARTS V32			
HOLE DIA. TOLERANCE			
.0135 - .125 +.004/-0.01			
.26 - .250 +.005/-0.01			
.251 - .500 +.008/-0.01			
.501 - .750 +.008/-0.01			

AeroAntenna Technology Inc
AS9100 CERTIFIED CO.

TITLE: ANTENNA, GPS L1/L2, GLONASS G1/G2 AND L-BAND

SIZE: B CAGE CODE: OUVG2 DRAWING NO.: AT1675-32 REV: B

SCALE: NONE I:\CAD\AT1675\32\AT1675-32_B SHEET 1 OF 1

www.hypertech.co.il | sales@hypertech.co.il 03-9243358:קטק 03-9243352:ל 7042.י.ת.י 14.אודם.ר 7042.י.ת.י 14.אודם.ר

AT1675-32